

Meetings and Events
BreakFree Grand Pacific



BreakFree [®]
GRAND PACIFIC



Business at BreakFree Grand Pacific

CONFERENCES

If you're looking for great value, a modern and well- equipped conference venue, then look no further. BreakFree Grand Pacific is the perfect place to hold your next conference, meeting, product launch or event.

BreakFree Grand Pacific sits right on the waterfront at Caloundra in a relaxed environment, where your delegates will feel revived, refreshed and ready to get down to business. We have all the facilities you'll need to run a successful event, with 2 spacious meeting rooms which can accommodate up to 130 delegates. Cold water, mints, pens and paper will be provided for your delegates, as well as some light refreshments.

Our dedicated conference coordinator will assist you in organising all the details for your event, including AV hire and accommodation if required.

PACKAGES

BreakFree Grand Pacific have a range of packages on offer including Full Day and Half Day Delegate packages. Breakfast and dinner recommendations are also available.

ACCOMMODATION

At BreakFree Grand Pacific you can enjoy self-contained accommodation and fantastic Sunshine Coast resort facilities without the hefty price tag.

With 1, 2 and 3 Bedroom Apartments, there's accommodation to suit singles, couples, families and groups.

Our apartments are self-contained with all the mod cons you would expect, as well as a spa and a large private balcony or patio with garden or ocean views.

To find out more and to book your next conference or meeting, call our Sunshine Coast Events Office on (07) 5455 2231 or email grandpacific.conf@breakfree.com.au

Conference Room	Size (M)	Theatre	Classroom	U-Shape	Boardroom	Cocktail	Banquet	Caberet
Osprey Room	60	60	30	25	18	60	30	24
Pelican Room	70	70	36	30	18	70	50	40
Osprey and Pelican	130	130	66	55	42	130	90	80

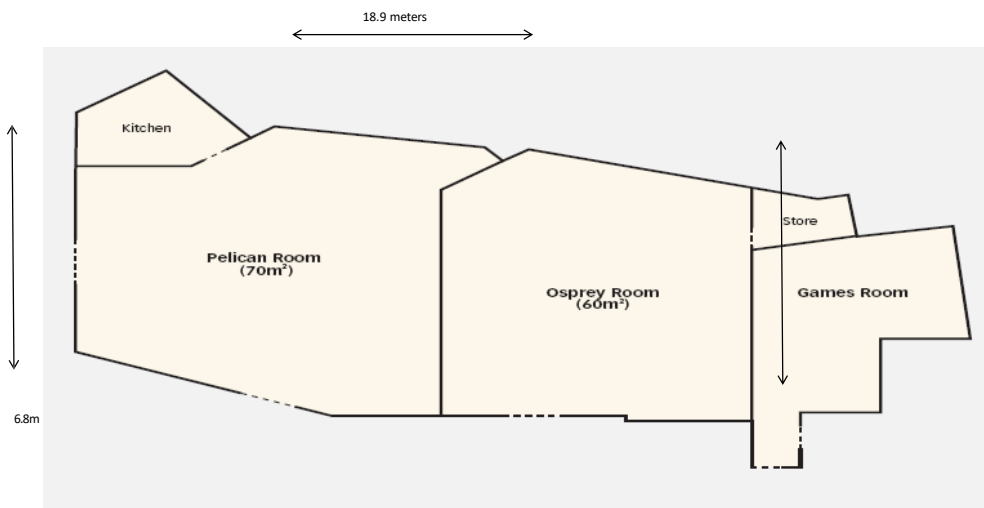



Great Packages, Even Better Prices

DELEGATE PACKAGES

Half Day Delegate Package - from \$60 per person

Minimum of 15 delegates

- Venue hire for up to 4 hours (between 09:00-17:00*)
- Continuous tea and coffee
- Morning/Afternoon Tea and Lunch
- Whiteboard and Projection Screen
- Notepads and pens
- Water and cool mints on tables
- Wi-Fi

Full Day Delegate Package - from \$70 per person

Minimum of 15 delegates

- All day venue hire (between 09:00-17:00*)
- Continuous tea and coffee
- All day catering
- Whiteboard and Projection Screen
- Notepads and pens
- Water and cool mints on tables
- Wi-Fi

Flexible Options

If you are looking for a bit more flexibility when it comes to your Day Delegate Package, the team at BreakFree Grand Pacific can customize and tweak inclusions to create a personalised package to suit your every need. Just speak to one of our dedicated conference coordinators who will assist in tailor making your next conference.

** Additional venue hire fees may apply for events taking place prior to 09:00 and 17:00.*



Catering

COFFEE BREAKS

Tea and Coffee - \$5.00 per person

Freshly brewed coffee and assorted teas, served for a 30 minute duration

Continuous Tea and Coffee

Freshly brewed coffee and assorted teas, served for the duration of your conference

Half Day \$8.00 per person

Full Day \$12.50 per person

Morning or Afternoon Tea - \$15.00 per person

Freshly brewed coffee and assorted teas, served with a selection of bakery items and cookies (30 minute duration)

BEVERAGES

Pay as you go: Delegates can pay for own drinks as ordered throughout the event.

Bar Tab: Please discuss with our dedicated conference coordinator about a suitable amount to put on a bar tab for your delegates to enjoy.

BYO: \$12.00 corkage fee per bottle/6 pack of drinks.

LUNCH

Options include:

- Baguette and wrap platters
- Bento boxes
- Salad bar

Prices from \$35.00 per person. Please contact your event coordinator for further details.

SELF-CATERING

We are happy to discuss self-catering on a case-by-case basis, please contact your event coordinator for further details. Fees apply.



TEAM BUILDING BY BE CHALLENGED

Since 2008, Be Challenged have specialized in workshops and programs designed to foster team cohesion, develop personal growth skills and job satisfaction.

Whether you are looking to develop your team's skills, drive performance and leadership, give back to the community or simply have some fun, Be Challenged has a program to suit for groups of 5-1,000 plus people. All programs have been professionally developed using scientifically proven strategies, and are then tailored to suit your specific objectives, group size and location. Plus, every program booked results in giving through Giving Partner B1G1.

Whether delivering a program indoors, outdoors, virtually or hybrid, key learning outcomes are teamwork, communication, planning and leadership, along with practical skills around problem-solving and strategic thinking.

LOCATION

BreakFree Grand Pacific is conveniently located in the heart of Caloundra. Situated on Bulcock Street and backing on to the Esplanade, you will park your car and not need to get back in it until you leave. We are walking distance away from Coles, Woolworths, BWS and Dan Murphys. Additionally, we are also just a short walk to The Events Centre.

AIRPORTS

Sunshine Coast Airport is located in Marcoola which is a 30 minute car ride from the resort. Transfers to and from the airport start at \$34.00 per person.

Brisbane Airport is an hour car trip the resort, with transfers to and from the airport starting at \$45.00 per person.

NEARBY SPORTING FACILITIES

BreakFree Grand Pacific have a number of sporting complexes which are in close proximity.

Caloundra Indoor Stadium is located on North Street which is only a 4 minute drive or 20 minute walk from the resort.

Sunshine Coast Stadium is located on Nicklin Way and is a 14 minute drive from the resort.

Great value. Great locations. Great breaks.

BreakFree Grand Pacific

100 Bulcock Street
Caloundra, QLD 4551

Phone: (07) 5436 4444

Email: grandpacific.conf@breakfree.com.au

Website: www.breakfree.com.au/grand-pacific

BreakFree 
GRAND PACIFIC